



MPS Extension Bracket



FEATURES

- Modular configuration
- Sleek Profile
- Vandal and Weather Proof
- Service from Back



Verisys
Registrars®
ISO 9001:2008
Certified

 Made in the USA

Overview

The MPS Extension Bracket provides a variety of options when placing a Campbell Company pedestrian station. The extension bracket allows the push button to be moved out as much as 18", great for bringing older crosswalks into compliance with current MUTCD and ADAAG guidelines. The MPS Extension Bracket (GMB) also allows for mounting two pedestrian stations on smaller diameter poles.

Mounting Options

The MPS Extension Bracket can be banded or bolted to the pole. The mounting holes on the pole mount bracket are slotted allowing for the use of existing holes. The mounting adapter plate is designed to allow all Campbell Company pedestrian stations to be quickly and easily installed. The design provides service wires to be routed through the lower tube. Each pole mount bracket is equipped with a threaded chase nipple that protects the lead in wires from sharp edges as well as providing drip protection. The brackets come with adjustable rubber buttons that snug securely to any diameter pole.

Materials

The extension bracket plates and extension tubes are machined from 6061 T6 Aluminum. All mounting hardware is stainless steel. MPS Extension Brackets are powder coated.



90 degree adapter

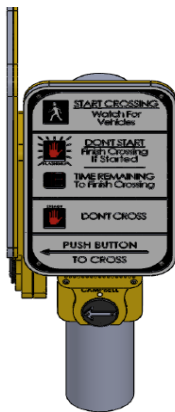
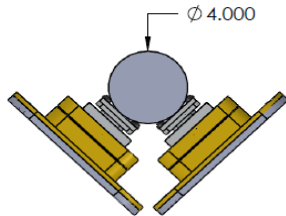

MPS Extension Bracket GMB

- Ganged Mounting Bracket allow 2 9X15" stations to mount on a 4" pole.

Power Coated Colors

- Yellow (Y)
- Textured Black (B)
- Green (G)
- Clear Coat Natural (N)

Installation

- Screw in the threaded chase nipple
- Pull wires through the lower tube into the button cup
- Attach pole base to the pole: band or bolt
- Attach the Pedestrian station to the extension bracket face plate
- Attach traffic controller cabin field wires to the back of the push button and secure PPB to button cup

ABOUT

Campbell Company is the leading American manufacturer of pedestrian signal safety products, accessible pedestrian signals (APS) pedestrian push buttons, signs, and hardware.

ADDITIONAL INFORMATION

More information can be found at: www.pedsafety.com